



phone: 1300 301 885
email: enquiries@structuralpanels.com.au
web: www.structuralpanels.com.au

Tridek SIPs Design & Construction Guidelines:

Effective Date: 08/04/2024



Classic Series

(Min 5°)

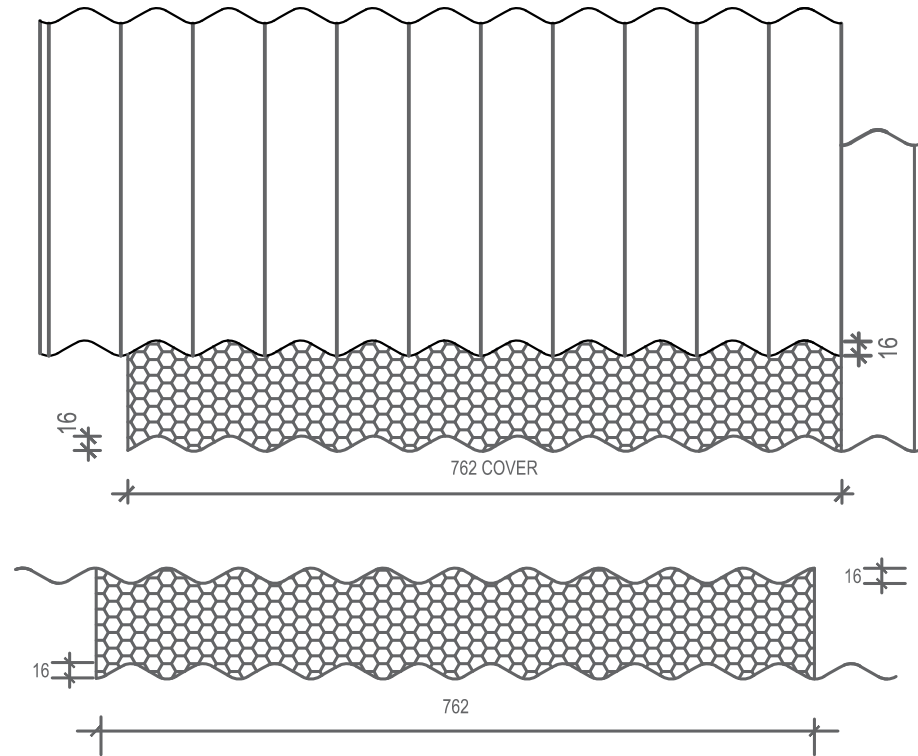

Pro Series

(Min 2°)

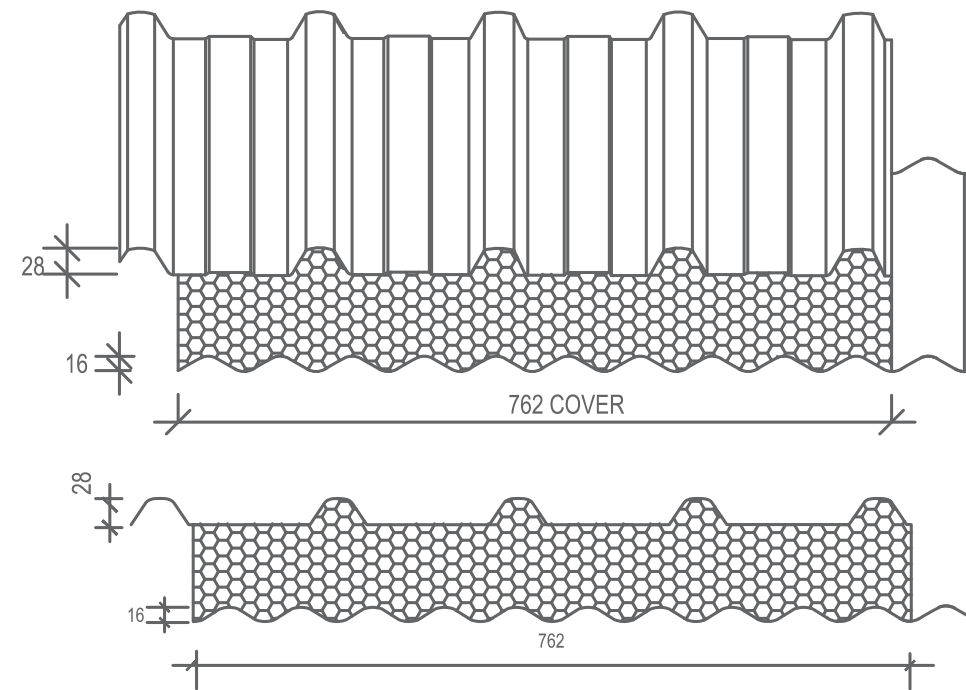

Smart Series

(Min 2°)

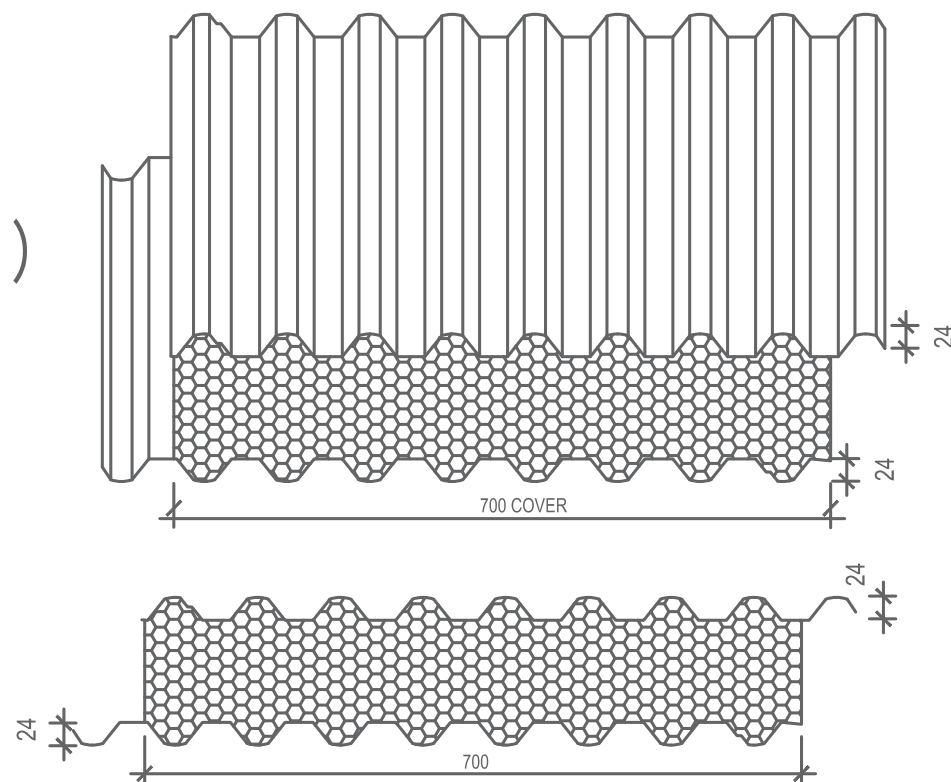

Icon Series

(Min 1°)

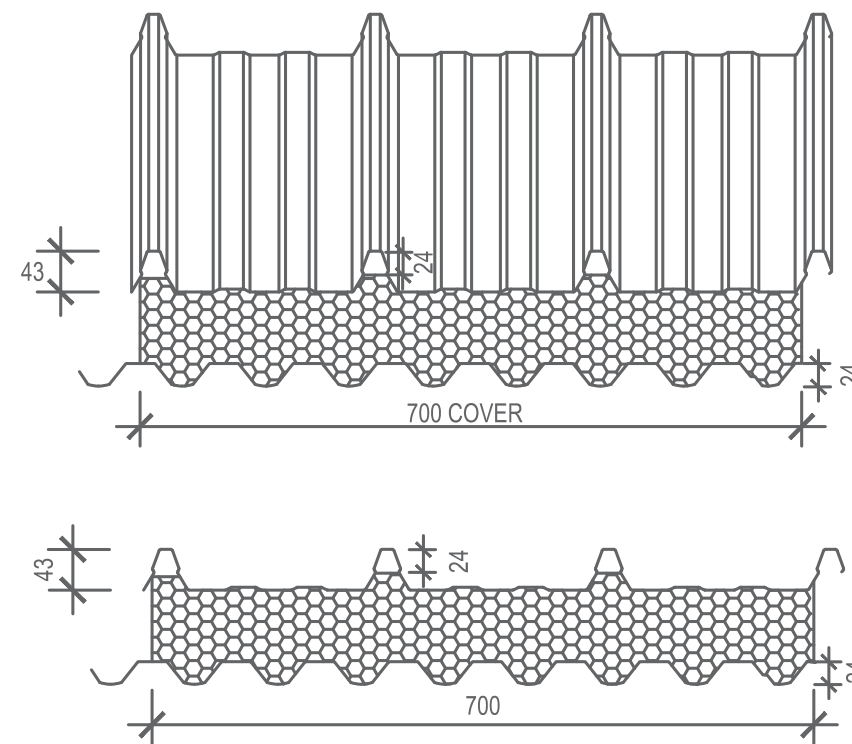

THIS DRAWING IS COPYRIGHT AND MUST NOT BE RETAINED, COPIED OR USED WITHOUT THE AUTHORITY OF STRUCTURAL PANELS AUSTRALIA.
PH. 1300 301 885
E. enquiries@structuralpanels.com.au

CLIENT TO CONFIRM DETAILS, COLOURS AND ALL DIMENSIONS AND APPROVE BY SIGNING PRIOR TO PRODUCTION COMMENCEMENT. IF THERE IS ANY DISCREPANCY BETWEEN THE SIGNED SHOP DRAWINGS + THE CUSTOMER'S REQUIREMENTS, THEN IT WILL BE THE CUSTOMER'S RESPONSIBILITY TO COVER ALL

COSTS OF RE-MANUFACTURING + FREIGHT OF THE PRODUCT.
APPROVED BY: _____ SIGNED
DATE:

ADDRESS:
Factory 52b, 37-39 East Street,
(access is via Mink Street, off East Street)
Daylesford, VIC 3460

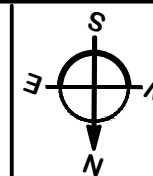

Tridek SIPs Detail:

Tridek SIPs Profiles

Structural Panels Australia

23062023

PAGE 1

DRAWN UI

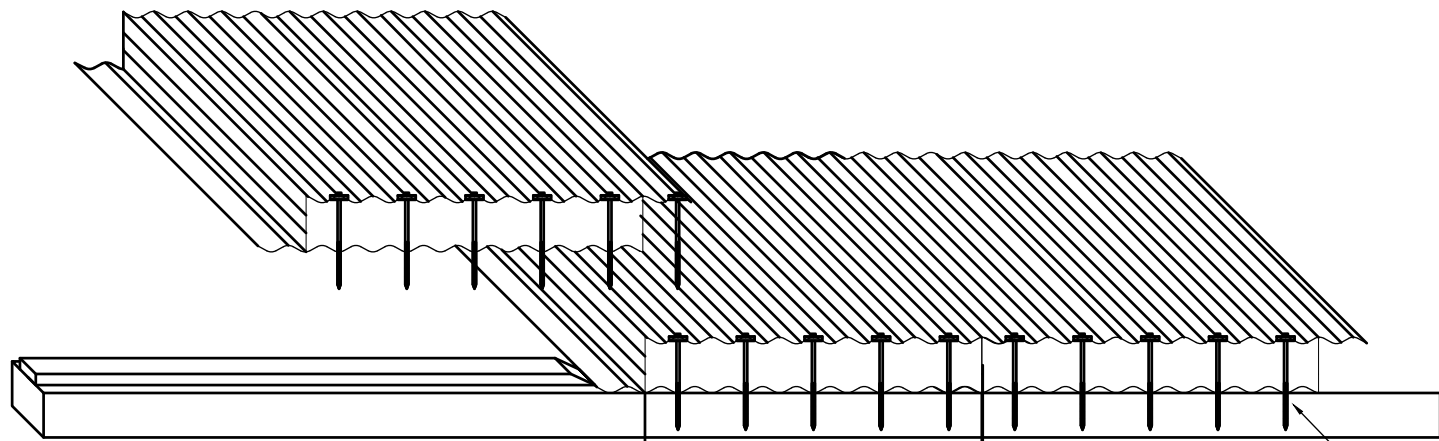

762mm
CONCEALED SERVICES CORE

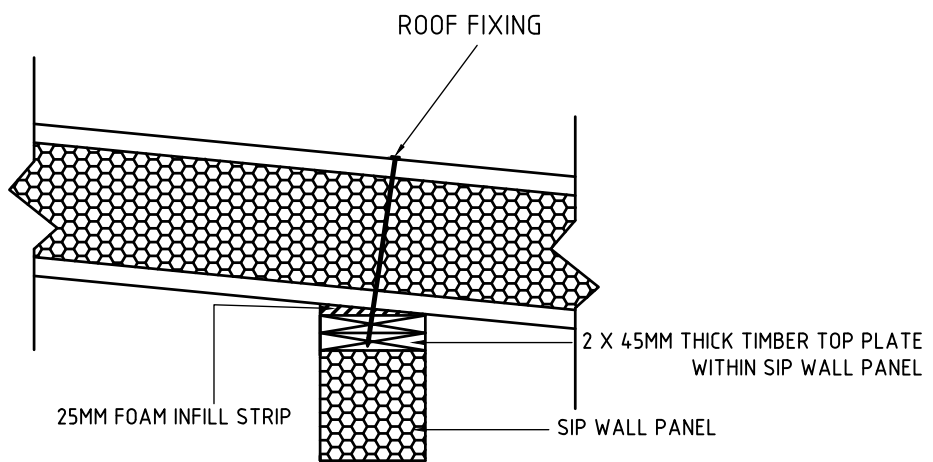

Notes : Roof Fixing
Minimum requirement has to be 14 gauge Hex Head structural screw in Galv coating for rust protection with least 50mm embedment length to the double top wall plates
Ex. Tridek SIPs 200mm panel required 250mm or higher roof fixing.

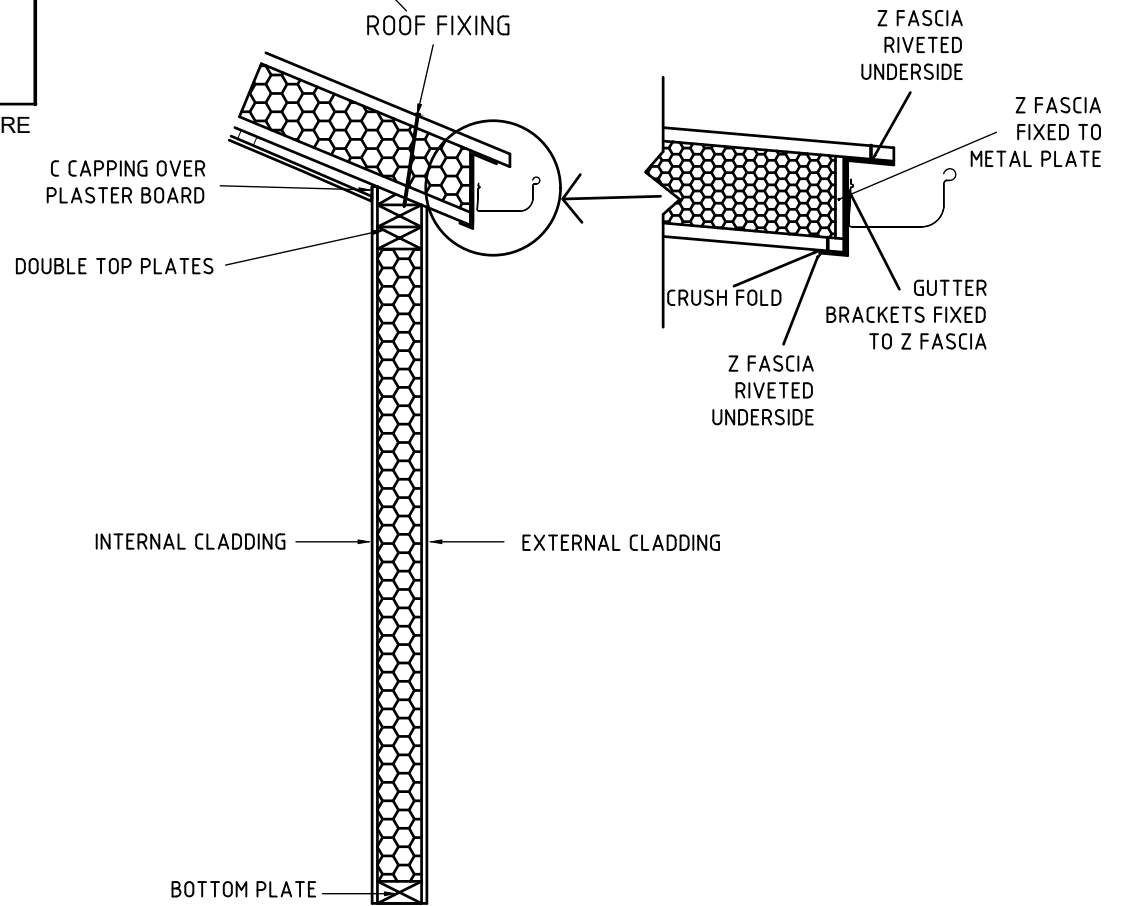
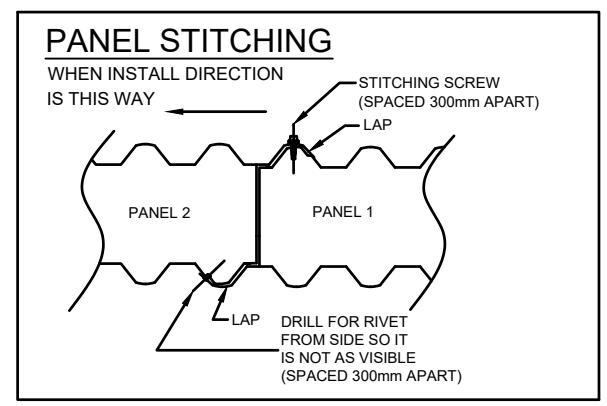

THIS DRAWING IS COPYRIGHT AND MUST NOT BE RETAINED, COPIED OR USED WITHOUT THE AUTHORITY OF STRUCTURAL PANELS AUSTRALIA.
PH. 1300 301 885
E. enquiries@structuralpanels.com.au

CLIENT TO CONFIRM DETAILS, COLOURS AND ALL DIMENSIONS AND APPROVE BY SIGNING PRIOR TO PRODUCTION COMMENCEMENT. IF THERE IS ANY DISCREPANCY BETWEEN THE SIGNED SHOP DRAWINGS + THE CUSTOMER'S REQUIREMENTS, THEN IT WILL BE THE CUSTOMER'S RESPONSIBILITY TO COVER ALL

COSTS OF RE-MANUFACTURING + FREIGHT OF THE PRODUCT.
APPROVED BY: _____ SIGNED
DATE:

ADDRESS:
Factory 52b, 37-39 East Street,
(access is via Mink Street, off East Street)
Daylesford, VIC 3460

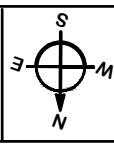

Tridek SIPs
Detail:

Tridek SIPs Roof Panel Fixing To SPA SIPs Wall Panel
Structural Panels Australia

28/09/2022
PAGE 1
DRAWN UI

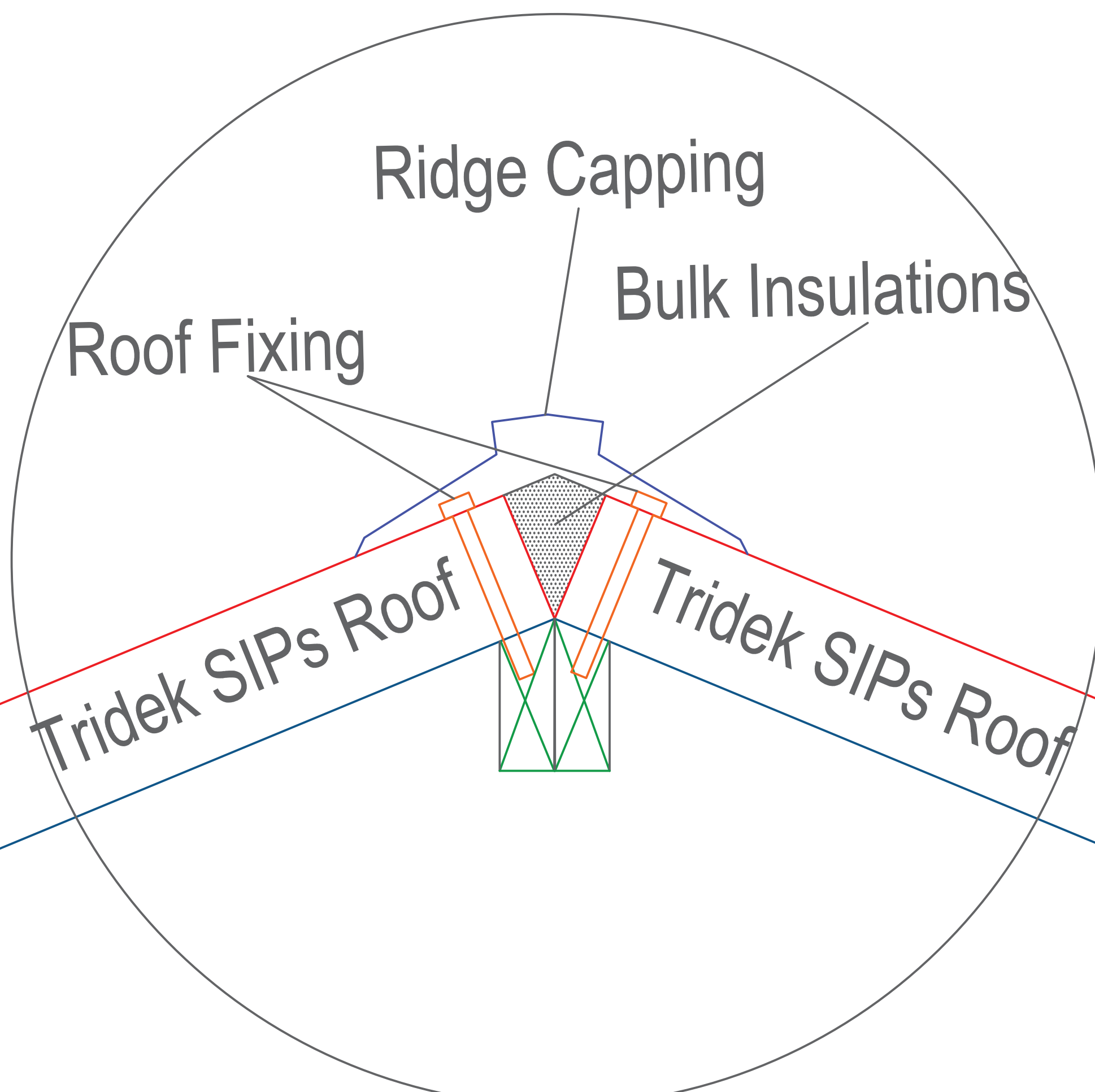

Ridge Capping

Bulk Insulations

Roof Fixing

Tridek SIPs Roof

Tridek SIPs Roof



THIS DRAWING IS COPYRIGHT AND MUST NOT BE RETAINED, COPIED OR USED WITHOUT THE AUTHORITY OF STRUCTURAL PANELS AUSTRALIA.
 PH. 1300 301 885
 E. enquiries@structuralpanels.com.au

CLIENT TO CONFIRM DETAILS, COLOURS AND ALL DIMENSIONS AND APPROVE BY SIGNING PRIOR TO PRODUCTION COMMENCEMENT. IF THERE IS ANY DISCREPANCY BETWEEN THE SIGNED SHOP DRAWINGS + THE CUSTOMER'S REQUIREMENTS, THEN IT WILL BE THE CUSTOMER'S RESPONSIBILITY TO COVER ALL

COSTS OF RE-MANUFACTURING + FREIGHT OF THE PRODUCT.
 APPROVED BY: _____ SIGNED
 DATE:

ADDRESS:
 Factory 52b, 37-39 East Street,
 (access is via Mink Street, off East Street)
 Daylesford, VIC 3460

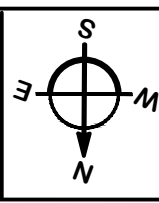

Detail: Tridek SIPs Roof Panels & The Ridge Beam Fixing Detail 1
Structural Panels Australia

02/08/2023
 PAGE 1
 DRAWN UI

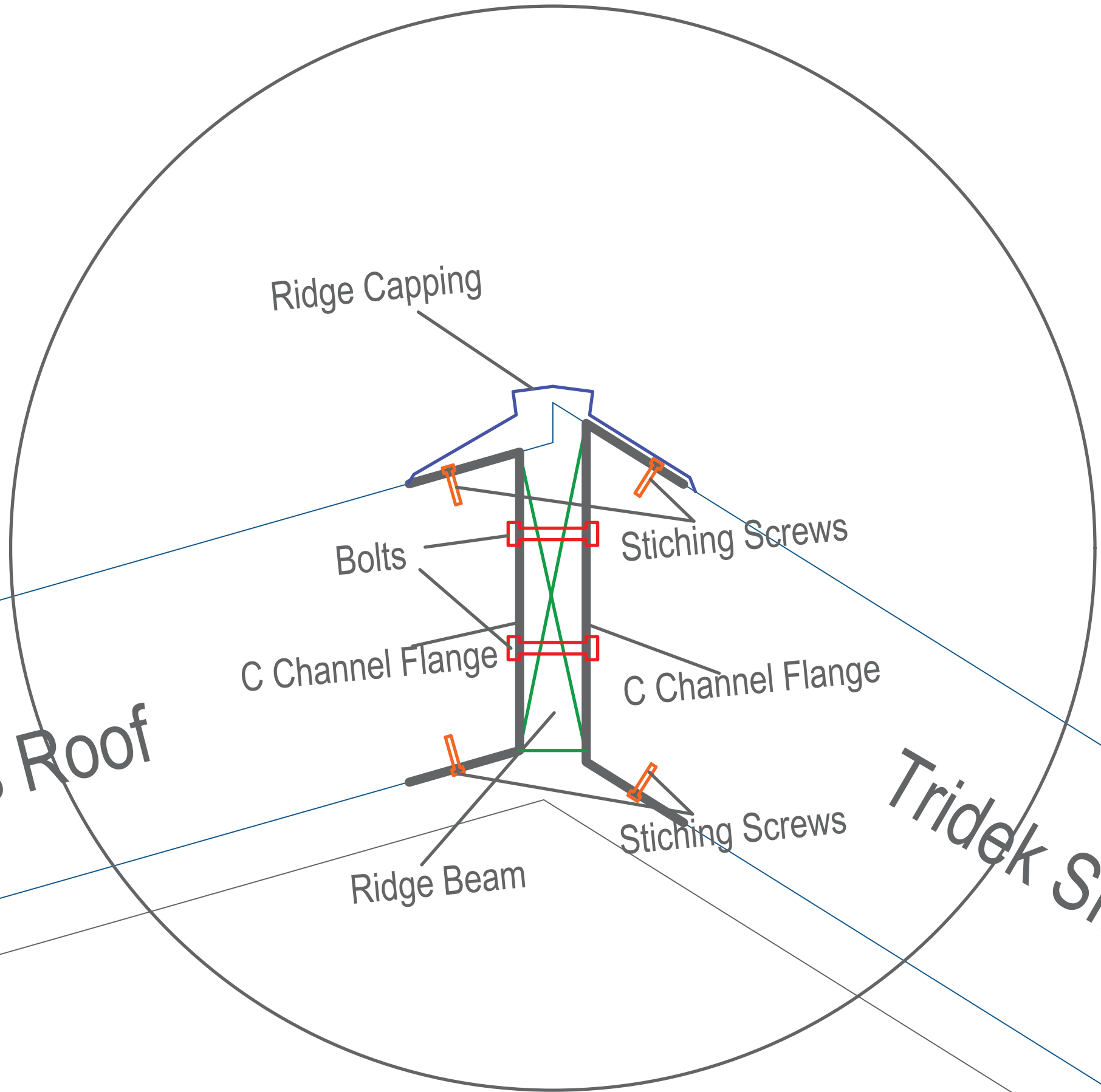

Tridek SIPs Roof

Tridek SIPs Roof

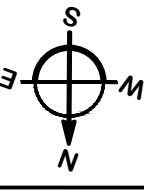

Note : Laying direction from the gutter end.

LEFT TO RIGHT

STITCHING SCREW SPACED 300mm APART
 WHEN INSTALL DIRECTION IS THIS WAY

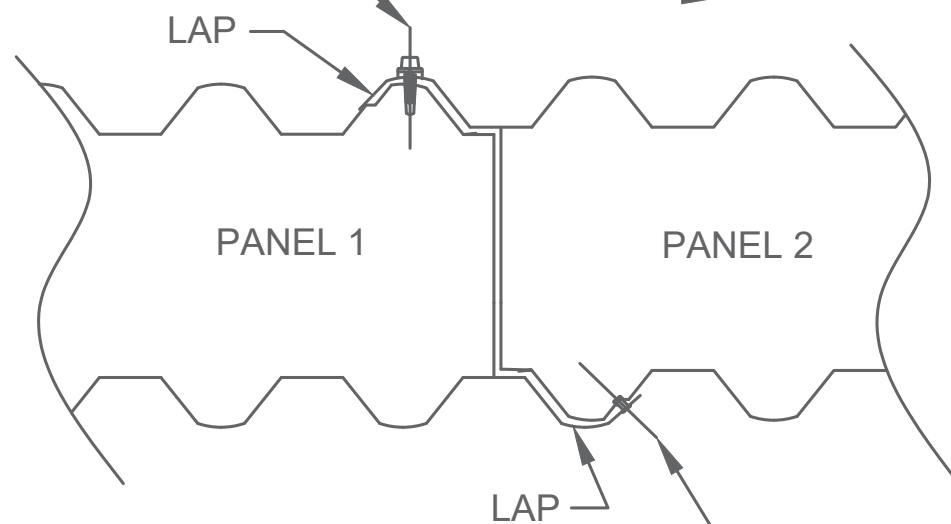

DRILL FOR RIVET (IF UNDERSIDE EXPOSED)
 FROM SIDE SO IT IS NOT VISIBLE
 OR STICHING SCREW (IF THERE IS A CEILING)
 SPACED 300mm APART

RIGHT TO LEFT

WHEN INSTALL DIRECTION IS THIS WAY
 STITCHING SCREW SPACED 300mm APART

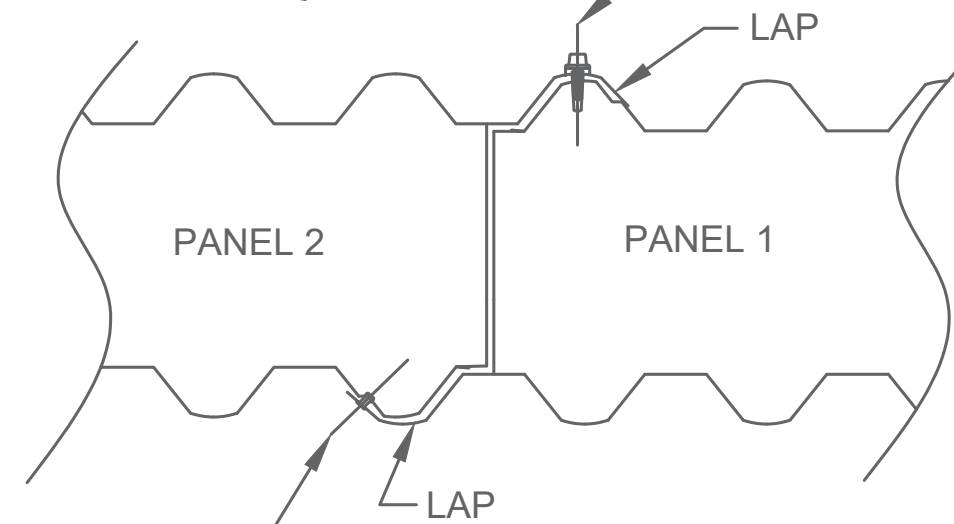

DRILL FOR RIVET (IF UNDERSIDE EXPOSED)
 FROM SIDE SO IT IS NOT VISIBLE
 OR STICHING SCREW (IF THERE IS A CEILING)
 SPACED 300mm APART

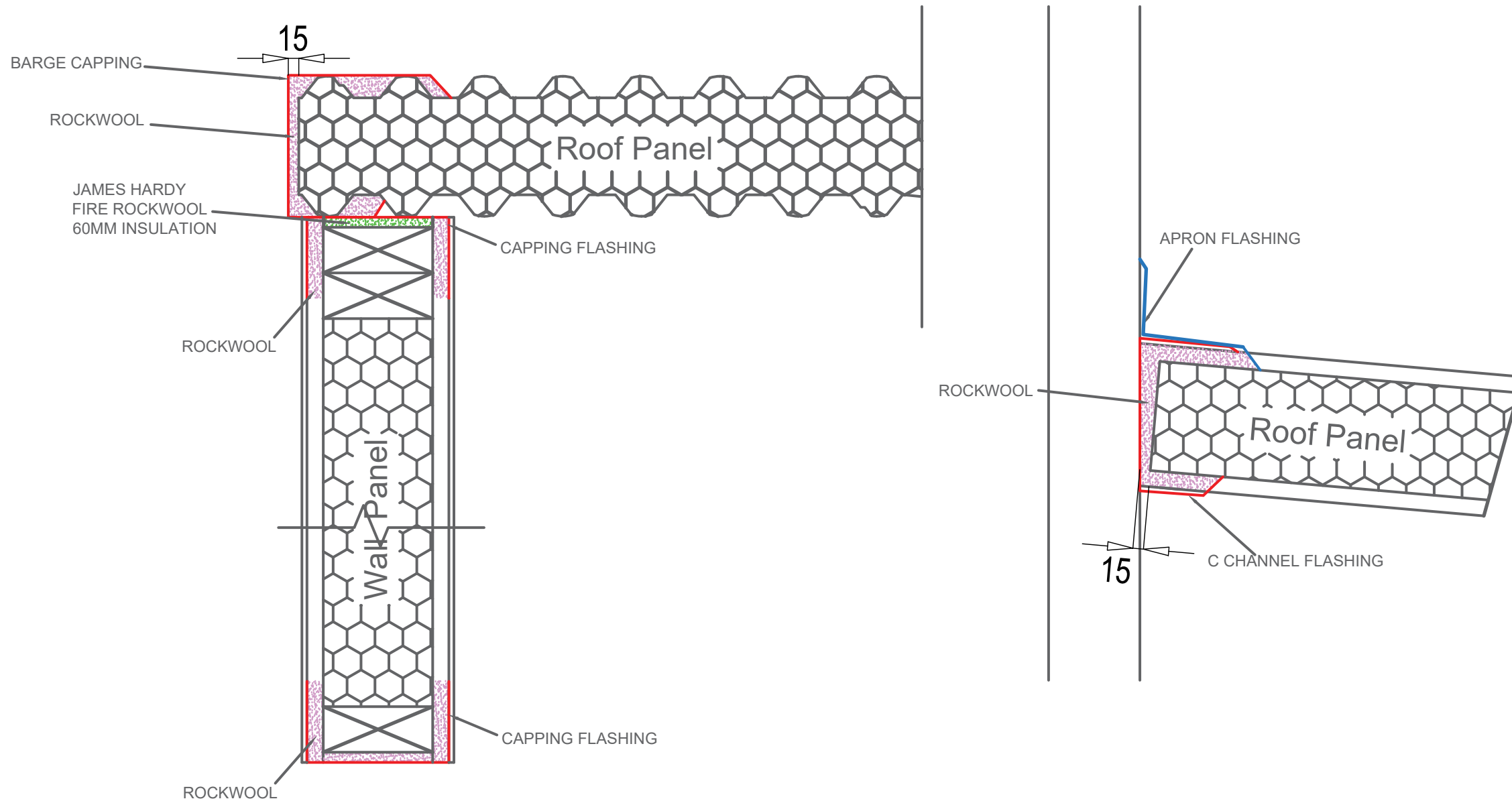

- Notes:
1. All the flashing's to be 0.55BMT or higher.
 2. All the flashing to be suite as per the roof profiles.
 3. All the gaps between panels and flashings cannot be more than 3mm.
 4. Minimum 15mm thick 70kg/m3 James Hardy Fire Rockwool Insulation.

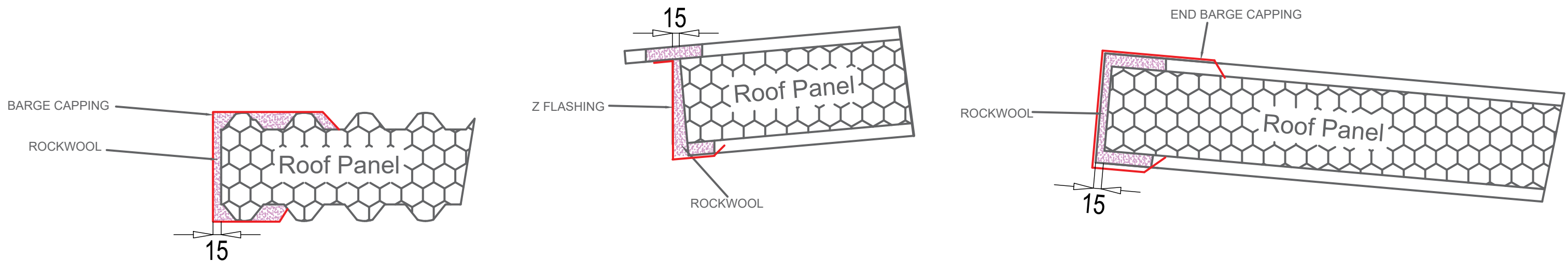

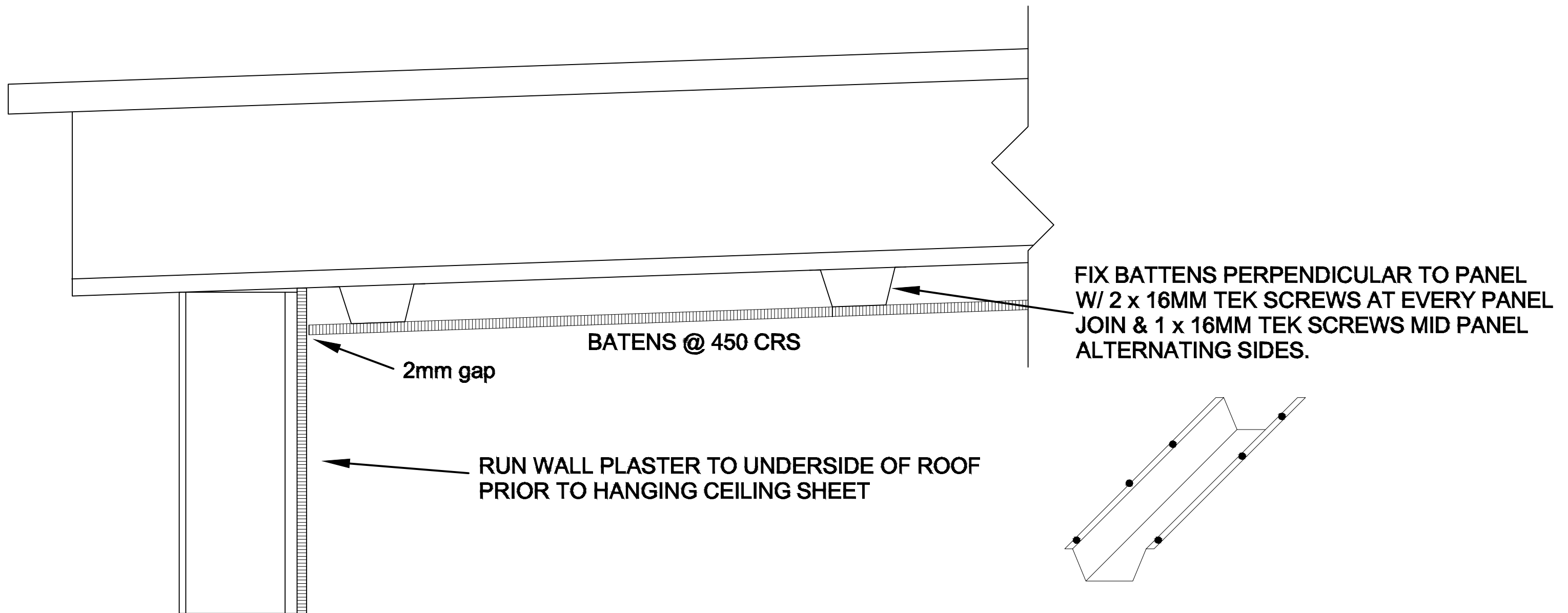

TRIDEK ROOFING TYPICAL PLASTER WALL/CEILING INSTALLATION

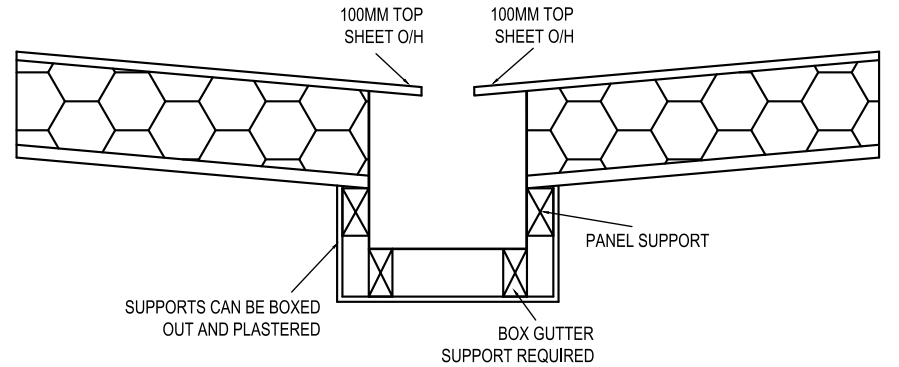
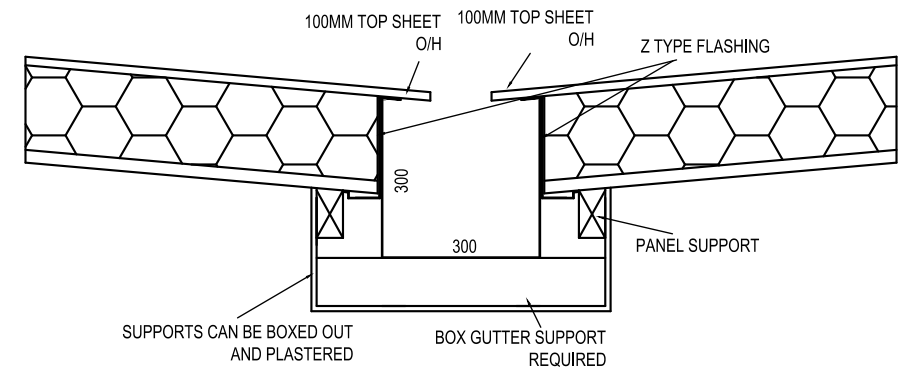
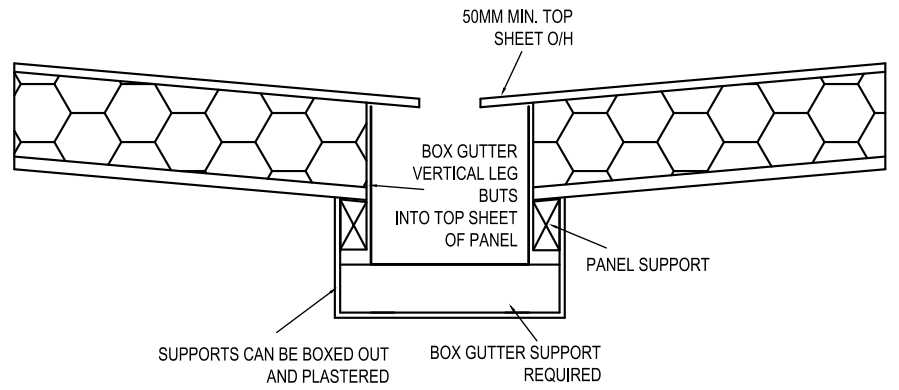
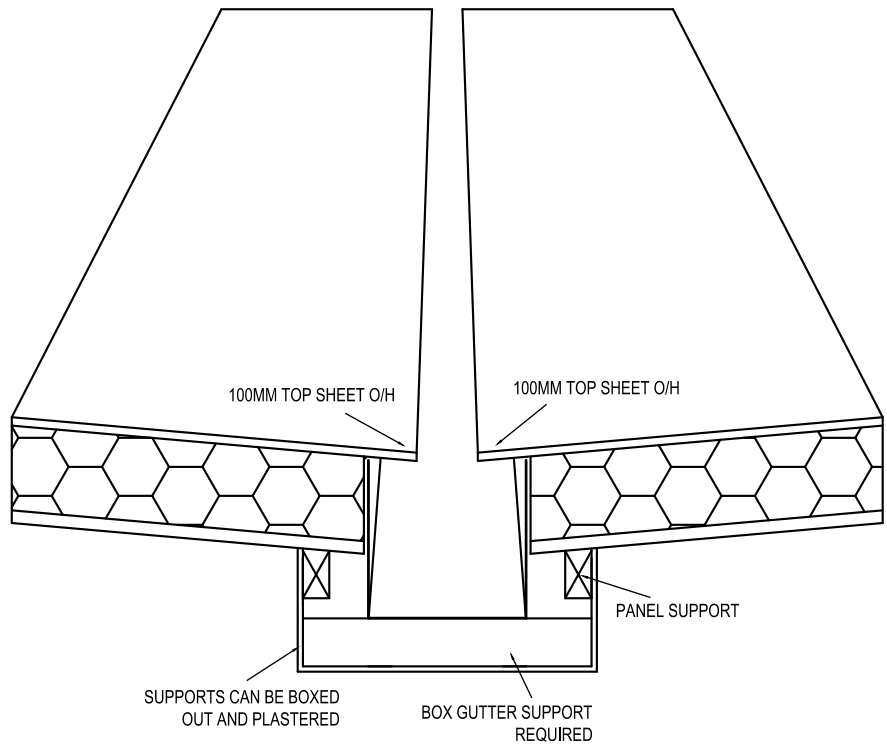

THIS DRAWING IS COPYRIGHT AND MUST NOT BE RETAINED, COPIED OR USED WITHOUT THE AUTHORITY OF STRUCTURAL PANELS AUSTRALIA. PH. 1300 301 885 E. enquiries@structuralpanels.com.au

CLIENT TO CONFIRM DETAILS, COLOURS AND ALL DIMENSIONS AND APPROVE BY SIGNING PRIOR TO PRODUCTION COMMENCEMENT. IF THERE IS ANY DISCREPANCY BETWEEN THE SIGNED SHOP DRAWINGS + THE CUSTOMER'S REQUIREMENTS, THEN IT WILL BE THE CUSTOMER'S RESPONSIBILITY TO COVER ALL

COSTS OF RE-MANUFACTURING + FREIGHT OF THE PRODUCT. APPROVED BY: _____ SIGNED DATE:

ADDRESS: Factory 52b, 37-39 East Street, (access is via Mink Street, off East Street) Daylesford, VIC 3460

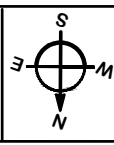

Tridek SIPs Detail: Tridek SIPs & Box Gutter Connection Details

Structural Panels Australia

05/08/2021
PAGE 1
DRAWN UI

SHEETS TURNED UP AT HIGH END

STRUCTURE ON HIGH SIDE RAISED BY DEPTH OF SHEETING PLUS 15MM ABOVE LOW SIDE

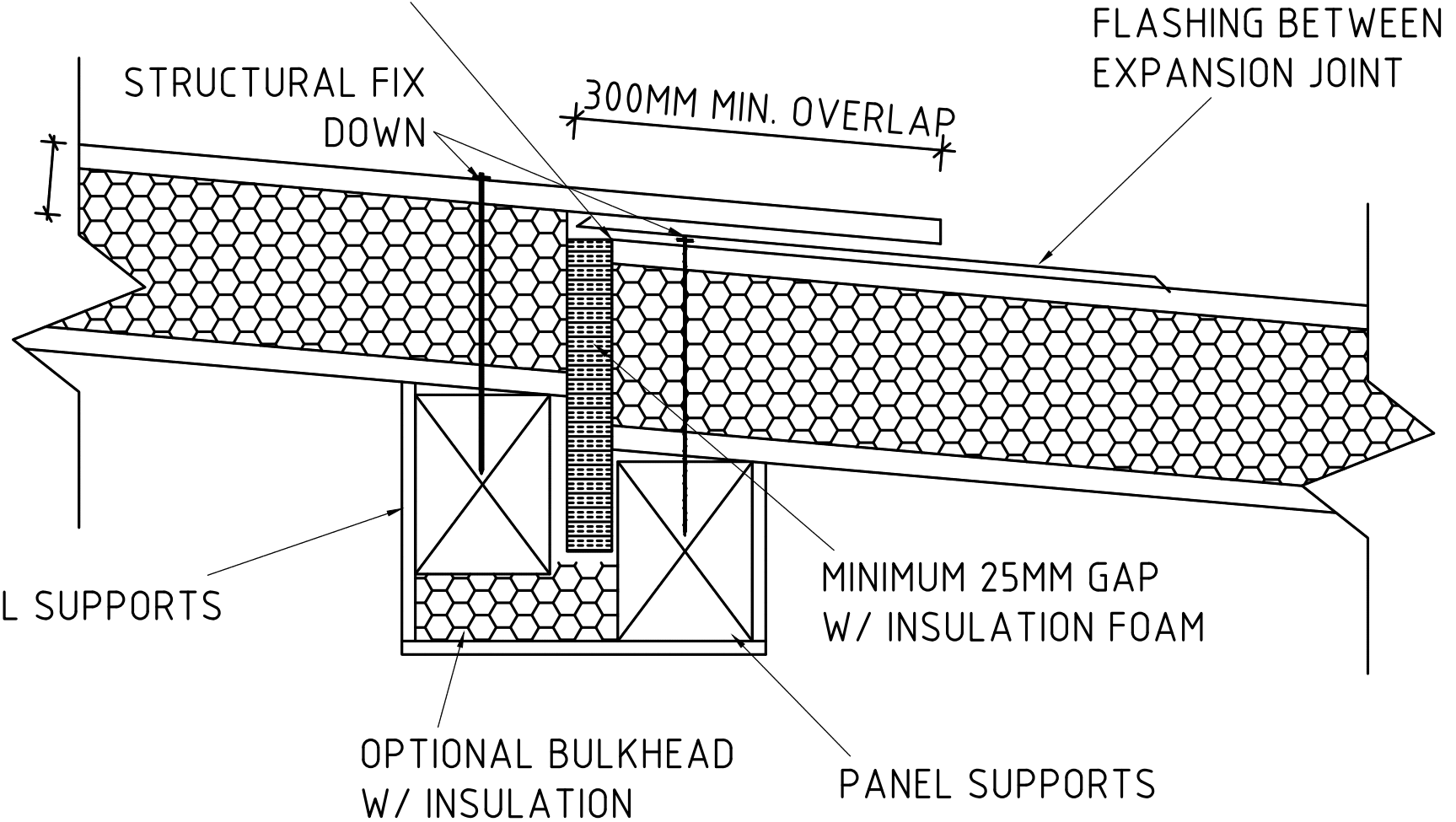

THIS DRAWING IS COPYRIGHT AND MUST NOT BE RETAINED, COPIED OR USED WITHOUT THE AUTHORITY OF STRUCTURAL PANELS AUSTRALIA.
PH. 1300 301 885
E. enquiries@structuralpanels.com.au

CLIENT TO CONFIRM DETAILS, COLOURS AND ALL DIMENSIONS AND APPROVE BY SIGNING PRIOR TO PRODUCTION COMMENCEMENT. IF THERE IS ANY DISCREPANCY BETWEEN THE SIGNED SHOP DRAWINGS + THE CUSTOMER'S REQUIREMENTS, THEN IT WILL BE THE CUSTOMER'S RESPONSIBILITY TO COVER ALL

COSTS OF RE-MANUFACTURING + FREIGHT OF THE PRODUCT.
APPROVED BY: _____ SIGNED
DATE:

ADDRESS:
Factory 52b, 37-39 East Street,
(access is via Mink Street, off
East Street)
Daylesford, VIC 3460

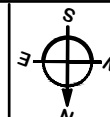

Tridek SIPs
Detail:

Expansion Joint Connection

Structural Panels Australia

05/08/2021

PAGE 1

DRAWN
UI

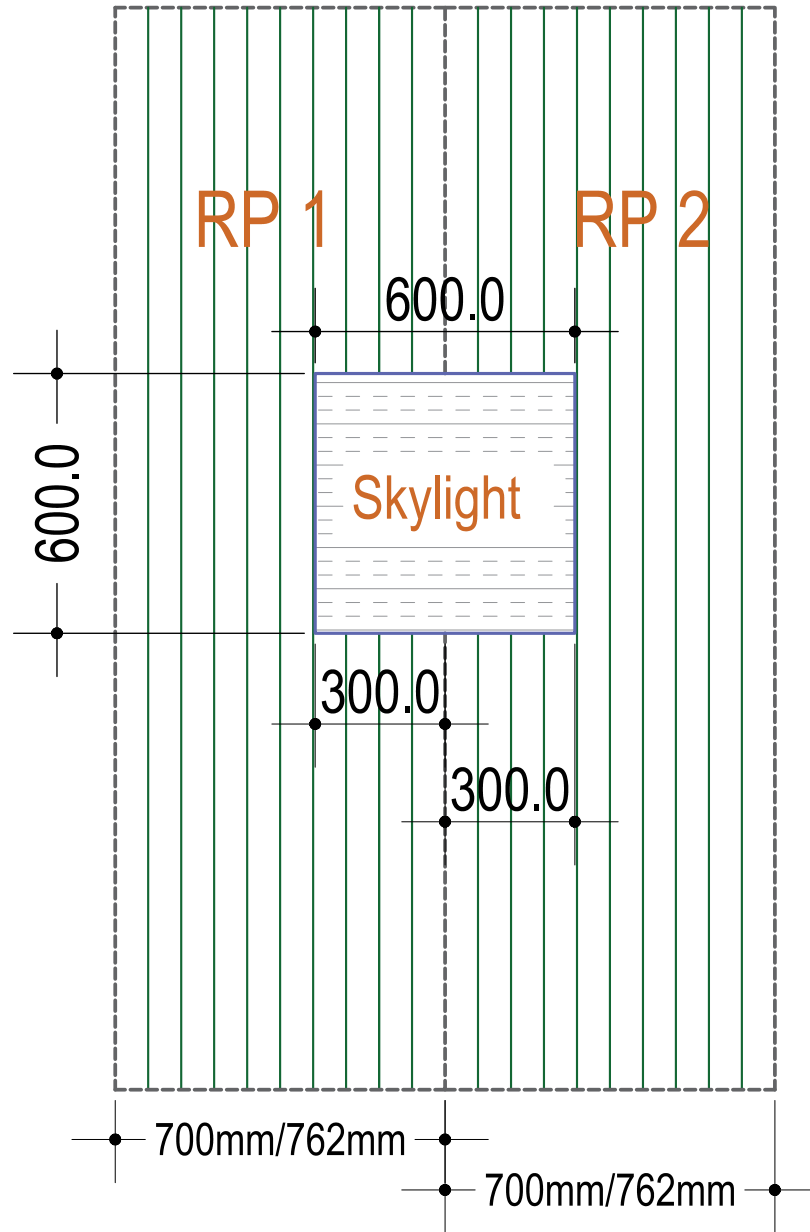

THIS DRAWING IS COPYRIGHT AND MUST NOT BE RETAINED, COPIED OR USED WITHOUT THE AUTHORITY OF TRIDEK CONTEMPORARY BUILDING.

CLIENT TO CONFIRM DETAILS, COLOURS AND ALL DIMENSIONS AND APPROVE BY SIGNING PRIOR TO PRODUCTION COMMENCEMENT. IF THERE IS ANY DISCREPANCY BETWEEN THE SIGNED SHOP DRAWINGS + THE CUSTOMER'S REQUIREMENTS, THEN IT WILL BE THE CUSTOMER'S RESPONSIBILITY TO COVER ALL

COSTS OF RE-MANUFACTURING + FREIGHT OF THE PRODUCT.
 APPROVED BY: _____ SIGNED
 DATE:

ADDRESS:
 Factory 52b, 37-39 East Street,
 (access is via Mink Street, off
 East Street)
 Daylesford, VIC 3460

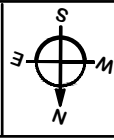

Sips Detail	Skylights on Tridek Roof Panels	05/05/2021
Structural Panels Australia		PAGE 1
		DRAWN UI



phone: 1300 335 801
email: enquiries@tridekroofing.com.au
web: www.tridekroofing.com.au
post: PO Box 220 Daylesford VIC 3460 Australia



Installation Manual

Part 1: Provided Material

<p>The Panel</p>			
<p>Expandable Foam Sealing Strip</p>		<p>Foam sealing strip is supplied to provide a thermal interior/exterior seal to the underside of panels at the exterior walls only. Exterior open space such as awnings etc do not require foam strip</p>	
<p>Barge Capping</p>	<p>0.6 Colobond or Zinalume Fix to Panel with 73 AS 4-3 rivets top and bottom sheet</p>		
<p>Z-Fascia</p>		<p>0.6 Colobond or Zinalume Fix to Panel with 73 AS 4-3 rivets top and bottom sheet</p>	
<p>Structural Screws Timber: 3/8 head size Metal: 5/16 head size</p>	<p>14-10x200 hex head Type 17 Class 3 coating roof screw into timber or self drilling into metal. No. 14 Cyclone Washer No. 14 EPDM Custom Orb Seal</p>		
<p>Lap Stitching Screws: 5/16 head size Rivets: 1/8 (3.2mm) hole required</p>	<p>10x16 hex head stitching screw with neo seal. Exterior Lap @ 300 centres</p>	<p>73 AS 4-3 Rivets Internal Lap @ 300 centres</p>	
<p>Gutters</p>		<p>NOTE: Smoothline Gutter & Accessories shown. Standard guttering is Quad Gutter unless indicated differently at time of order.</p>	
<p>Gutter Accessories</p>	<p>End Plates</p>	<p>Brackets</p>	<p>Pops</p>

Note: All of the above items are supplied unless otherwise indicated

PART 2: STORAGE, HANDLING & SAFETY ISSUES

The TRIDEK[®] panels will arrive on site via truck transportation from the factory.

Unload the panels from the truck and store on a flat surface on the ground, or alternatively directly onto roof frame. It's very important that the panels do not get damaged in any way by any lifting devices used ie. forks, hoists, crane etc.

When carrying the panels by hand, it is important to always carry the panels lifting from underneath. They should never be carried lifting from the top sheet as delamination may occur. Great care must be taken when transporting the panels as any damage will affect the overall finish. Gloves are highly recommended.

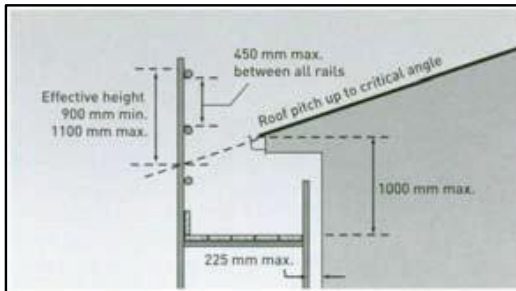

It is important that Scaffolding be installed (usually builder supplied) to the relevant authority standard as a catch scaffold to enable easy access to the roof. Appropriate harness or internal scaffolding/scissor lift, may need to be used during the laying stage of the panels. It is important that a JSA evaluation is completed onsite for each job as they are all different. The usual personal protective equipment should be used at all times. Use of vacuum lifters can be used with caution.

PART 3: PANEL INSTALLATION

Before starting, make sure all drawings and documentation are correct and signed. Assess the building for square and proceed to layout foam strip on all load bearing points on the exterior frame.

Work out the top and bottom side of each panel and identify the direction of the prevailing weather, so as to install away from it. Refer to shop drawings if unsure. Remove the overlap from the top sheet on the first panel, so as the capping will be able to be installed correctly later.

Lift the first panel into place with a crane. Check the positioning with the correct eaves and overhang on each edge. If panel is incorrectly placed, move accordingly.

As soon as the first panel is in the correct position, fasten it into the support structure using the correct wood screw or metal driller. Install these screws at every second rib.

Continue to lay out the panels, constantly checking that they are parallel as you go. Continue to screw down each panel into the support structure.

If the last panel needs to be adjusted, measure the amount to be cut and mark it off with a chalk line.

Cut the panel only with an approved cold cut saw or snips. Grinders are not to be used under any circumstances and will void warranty.

When all the panels have been laid out, the top sheet lap needs to be fastened at 300mm centres using stitching screws on the overlap.



Cut the barge capping to the correct length. Place into desired position ensuring that the capping for the top edge or peak of the roof covers each of the sides so as to stop leaking. Rivet the capping on the top edge into every lap joint as well as in the centre of the panel, top and bottom. Mitre the corner of the top edge capping only at 45 degrees, and rivet to the side capping top, side, and bottom.



For the capping along the run of the roof, rivet at 300mm centres, aligning with the stitching screws. Silicone the corner capping joints top, side, and bottom to ensure no leaking. Use only neutral cure silicon. All holes for rivets will need to be pre-drilled.

The Z-Fascia (if required) needs to be riveted at every lap joint as well as in the centre of the panel, as per the barge capping at the top edge.

If a box gutter is used, the top sheet will hang over 50mm so simply slide the box gutter underneath this overhang until it's tight up against the polystyrene.



The underside laps of the panels need to be fixed at 300mm centres using pop rivets. The rivet should be placed just off to the side of the rib towards the lap. All holes for rivets will need to be pre-drilled.

Any markings made on the underside during the installation can be washed clean with detergent and water. Under any circumstances do not use any solvents or abrasive cleaners as these will damage the finish. Tridek can supply on request a solvent specially formulated to remove glue if required.

Cleaning of the top sheet with a broom must be done at the end of every day during installation to ensure that no steel swarf is left behind as this will cause rust. Any other markings such as dirt/mud can be washed with detergent and water as before.

PART 4: SERVICES

The panels come with a 40mm diameter service duct running through them at the joints.

Electrical fixtures are ideally placed on panel joints. It is recommended that the electrical contractor is on site during installation.

The electrical contractor is able to run wiring from supporting walls through the service ducts to where they need to be placed.

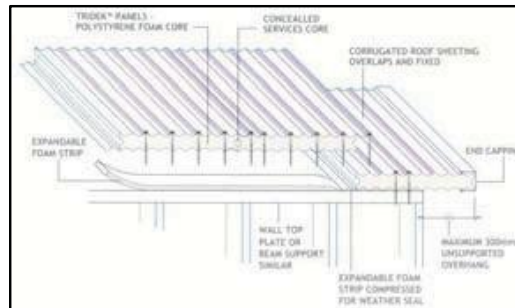

The underside sheet can be cut or drilled for the inlet or outlet of wiring.

Electrical fixtures that are not located on the panel joints can be wired by drilling an opening or by pushing a heated rod into the polystyrene to the required position.

Ceiling fan brackets should be mounted through the full depth of the panel by a bolt fitted with the correct screw with a cyclone washer and a neo.

Down lights can be fixed into the underside of the panel by placing a PVC sleeve into which the fitting can be fastened.

NOTE: Safety issues are extremely important and costly if ignored. The recommendations made in this document are not a comprehensive assessment of safety issues. These need to be looked at thoroughly for each and every job. On site safety for unloading and installation is solely the installer/ Builders Responsibility.

Fan/ Light Mounting Block

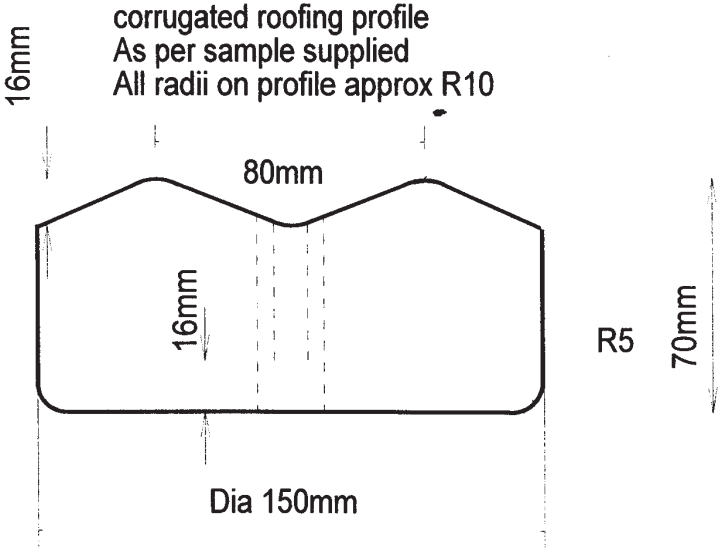
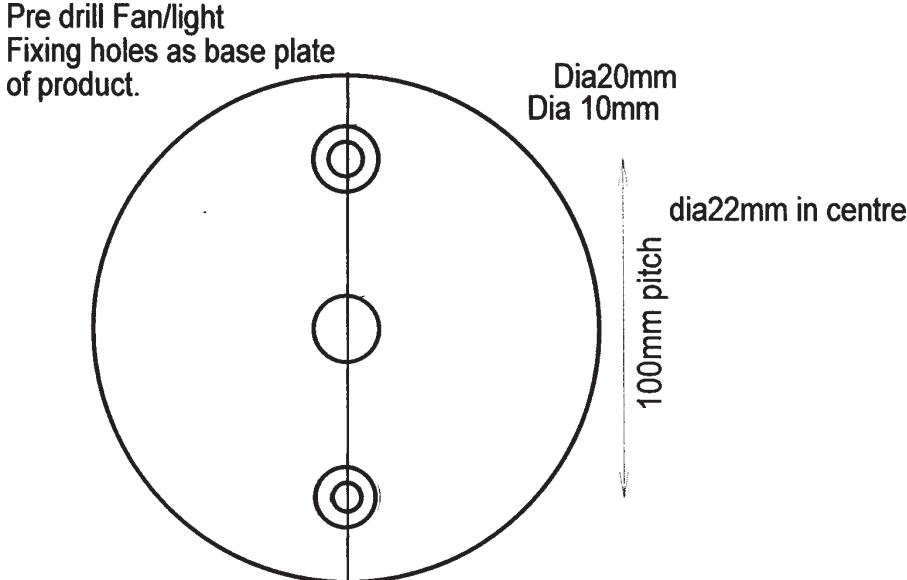

Tridek light mount block
Matl; PVC or Nylon (must be paintable)
Prefered raw colour white or off white
Order Qty from 10 to 100 off



phone: 1300 335 801
email: enquiries@tridekroofing.com.au
web: www.tridekroofing.com.au
post: PO Box 220 Daylesford VIC 3460 Australia



Maintenance Manual

Maintenance

The Colorbond® paint system on all TRIDEK Contemporary Roofing Panels is a highly durable and decorative finish. Simple maintenance of this finish by regular washing with fresh, clean water will not only enhance life but also maintain attractiveness for longer periods, thus protecting your asset.

Roof areas where the finish is automatically washed by rainwater do not usually require this maintenance.

Maintenance cleaning of TRIDEK Contemporary Roofing Panels is therefore required whenever the finish is not washed by rain. Examples of applications requiring maintenance cleaning include eaves and eaves gutters. Washing should be done at least every six months and more frequently in coastal areas where marine salt spray is prevalent and in areas where high levels of industrial fallout occur. Care should be taken to prevent the accumulation of salty deposits or industrial dirt.

Cleaning

Establish a regular routine for washing TRIDEK Contemporary Roofing Panels. Twigs, dust, leaves and fungal matter (debris) should be removed using the following procedure, taking care to ensure no damage occurs to the cladding during debris removal.



Sweep debris into a pile using a stiff, soft bristled brush (shovels or hard tools should not be used).

Place debris into a receptacle and lower to the ground. The whole roof and gutter then be washed down with a hose including high ends of gutters possibly protected by overhangs, rain heads, water spouts and overflow locations.

In cases where the regular maintenance referred above does not remove all the dirt which may have adhered to the surface of the paint, the following procedure should be carried out.

Wash the surface with a mild solution of pure soap or non-abrasive dish washing kitchen detergent in warm water. Application should be with a sponge, soft cloth or soft bristle nylon brush, and should be gentle to prevent shiny spots. The TRIDEK Contemporary Roofing Panels surface should be thoroughly rinsed with clean water immediately after cleaning to remove traces of detergent.

Never use abrasive or solvent type cleaners (turps, petrol, kerosene, paint thinners etc) on TRIDEK Contemporary Roofing Panels.

If cared for in accordance with these instructions, your TRIDEK Contemporary Roofing Panels will give many years of low maintenance life.

Precaution

To avoid the possibility of corrosion, it is advisable not to allow metals other than aluminium, galvanized steel, zinc/aluminium alloy coated steel or zinc to come into direct contact with TRIDEK Contemporary Roofing Panels.



Following trades and services

Persons involved in following trades and services need to be made fully aware of the consequences of their work. Warranties and guarantees previously issued may be rendered null and void if work conducted damages the roof. Additionally, all following trades must check the compatibility of their products and associated discharge by these products when installed on the roof system. Air conditioning system waste and condensate is not to discharge on the roof. This waste and condensate should be directed to the sewer system in accordance with the requirements of the relevant statutory authority.

Care must be taken not to use CCA treated timber on or above roof cladding, unpainted copper flashings and not to spill mortar onto the cladding.

A full register of persons and reasons for trafficking the roof must be documented and maintained.

Disclaimer

The information and advice contained in this manual is of a general nature only, and has not been prepared with your specific needs in mind. You should always obtain specialist advice to ensure that the materials, approach and techniques referred to in this manual meet your specific requirements.